



**HANDRAIL FITTINGS Ltd**

**Best Price - Best Quality - Best Service**

## **Catalogue 2018**

**Handrail Fittings Ltd**

**06 328 9619**

**[info@handrailfittings.co.nz](mailto:info@handrailfittings.co.nz)**

**[www.handrailfittings.co.nz](http://www.handrailfittings.co.nz)**

NB: This catalogue is not complete, please visit our website for full product details

## Handrail Bracket - Capri

Product Code: HBCS.

HBCS. handrail bracket coned flange Saddles to fit flat and curved tube (38 - 50mm)

AISI 304 and 316 stainless steel options

Manufactured to high quality specifications

Available in satin and mirror finish

Mild steel options also available

This handrail bracket complies with BIA acceptable solutions D1/AS1



### HBCS. Handrail Bracket

- Coned base
- 3 countersunk holes for easy fixing to wall stud
- 12mm diameter rod
- Saddles to fit flat or curved tube (38 - 50mm)
- Recommended spacing maximum 1000mm

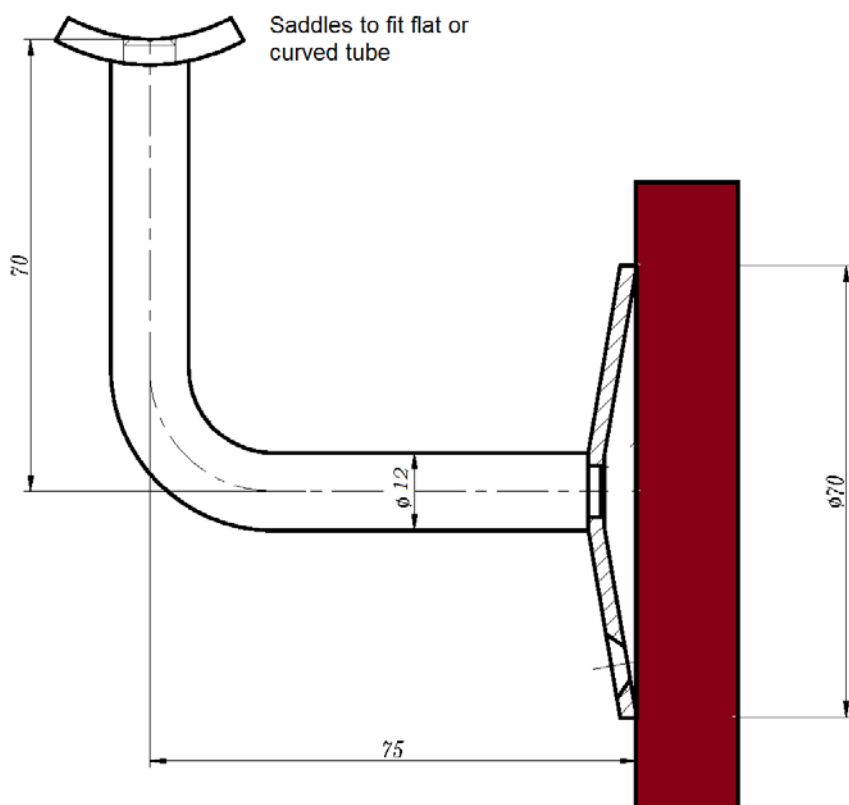

Also available without saddle  
Code HBCnh

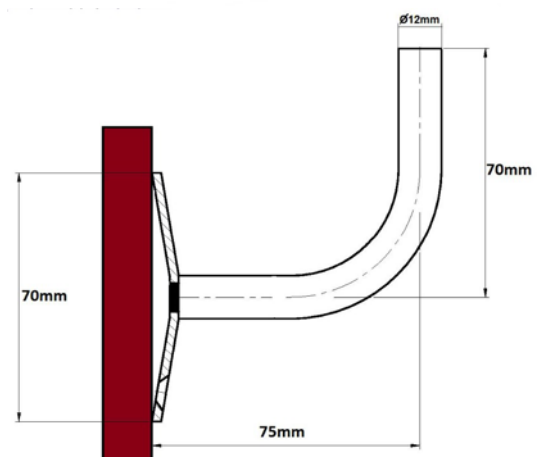



## Handrail Bracket – Vienna

Product Code: HBFS

HBFS. handrail bracket flat flange

Saddles to fit flat or curved tube (38 - 50mm)

AISI 304 and 316 stainless steel options

Manufactured to high quality specifications

Available in satin and mirror finish

This handrail bracket complies with BIA  
acceptable solutions D1/AS1

## HBFS Handrail Bracket

- Fixing plate machined from 5mm thick stainless steel
- 3 countersunk holes for easy fixing to wall stud
- 12mm diameter rod
- Saddle to fit flat or curved tube
- Recommended spacing maximum 1000mm

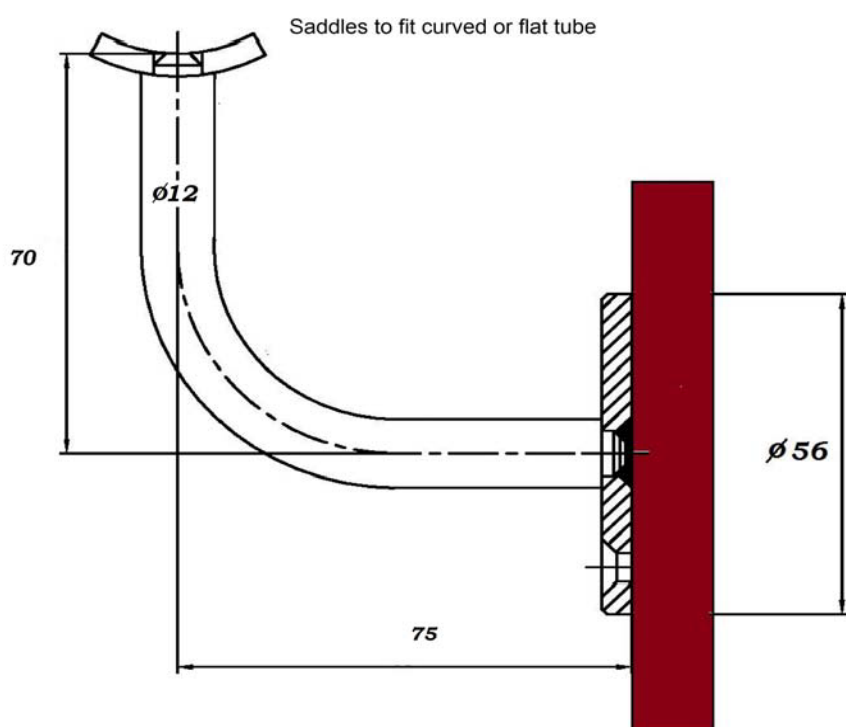

Also available without saddle  
Code HBFnh

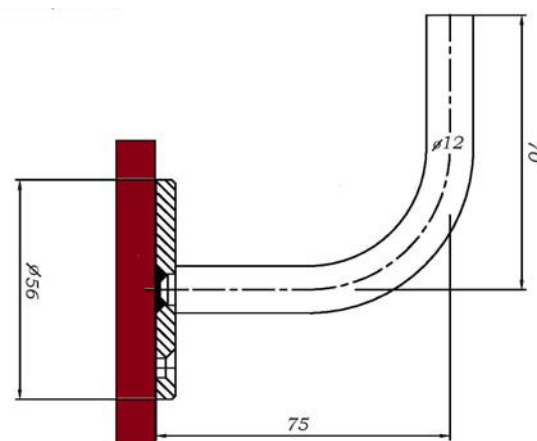

## Handrail Bracket - Sierra

Product Code: HBCFS

HBCFS handrail bracket flat flange

Saddles to fit flat and curved tube

AISI 304 and 316 stainless steel options

Manufactured to high quality specifications

Available in satin and mirror finish

This handrail bracket complies with BIA  
acceptable solutions D1/AS1



## HBCFS Handrail Bracket

- Base plate machined from 5mm thick stainless steel
- A single 8mm lag screw concealed fixing
- 12mm diameter rod
- Recommended spacing maximum 1000mm

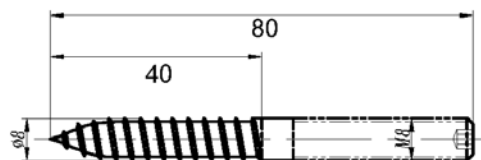

M8 80mm lag screw supplied

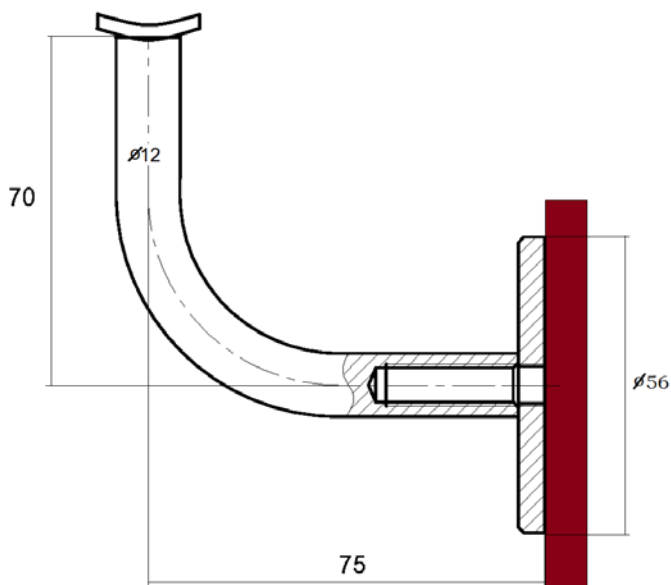

Also available as weld on  
Code HBCFnH

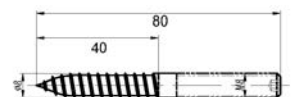

M8 80mm lag screw supplied

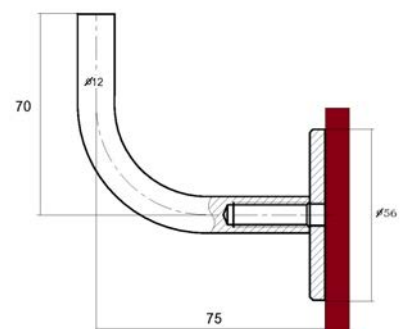



**Handrail Bracket - Sierra Pico**  
**Product Code: HBCFWS**

Concealed Fixing handrail bracket  
with a flat 30mm flange

Saddles to fit curved or flat tube

AISI 304 and 316 stainless steel options

Manufactured to high quality specifications

Available in satin and mirror finish

This handrail bracket complies with BIA  
acceptable solutions D1/AS1

## HBCFW Handrail Bracket

- Base plate machined from 5mm thick stainless steel
- A single 8mm lag screw concealed fixing
- 12mm diameter rod
- Recommended spacing maximum 800mm

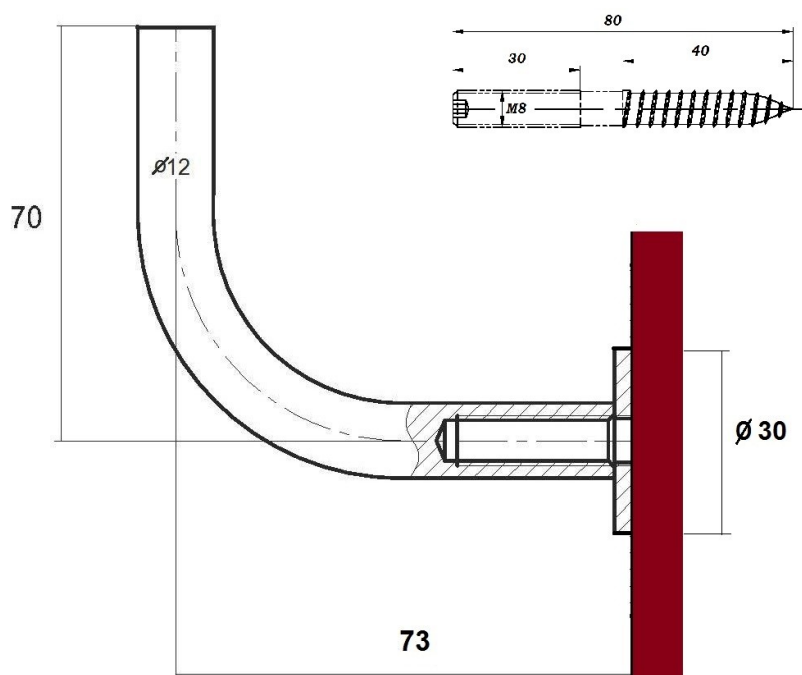

Handrail Fittings Ltd - 0800 HANDRAIL - 0800 426372

Also available without saddle  
HBCFWnh





## Handrail Bracket - Milano

Product Code: HBFCPS

HBFCP handrail bracket flat flange  
with cover plate

Saddles to fit flat or curved tube

Also available as weld on

AISI 304 and 316 stainless steel options

Manufactured to high quality specifications

Available in satin and mirror finish

This handrail bracket complies with BIA  
acceptable solutions D1/AS1

### HBFCPS Handrail Bracket

- Fixing plate machined from 5mm thick stainless steel
- 3 countersunk holes for easy fixing to wall stud
- 12mm diameter rod
- Recommended spacing maximum 1000mm

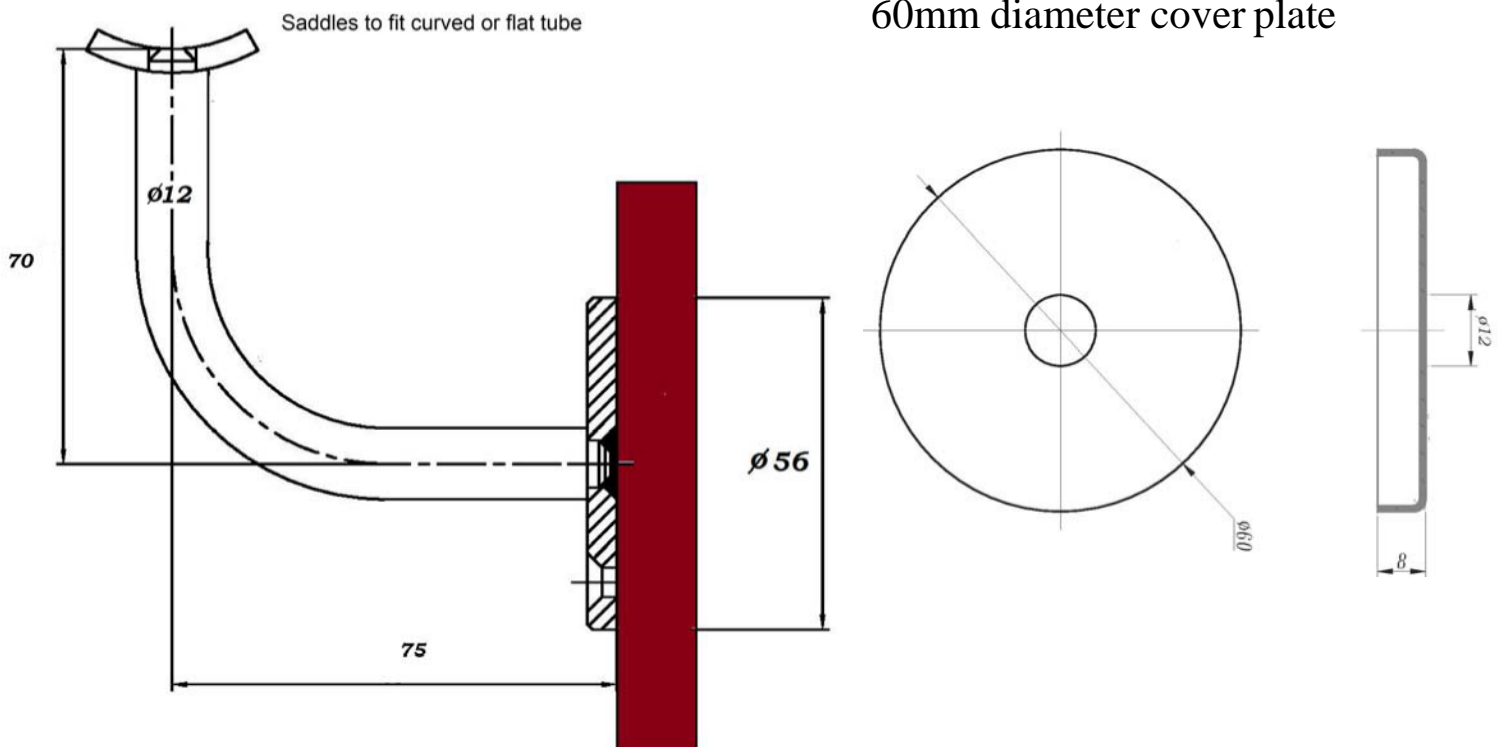



**Handrail Bracket - Quadro**  
**Product Code: HBSQCPS**

HBSQCP Square handrail bracket  
with cover plate

Saddles to fit curved or flat tube

AISI 316 Satin stainless steel

Manufactured to high quality specifications

This handrail bracket complies with BIA  
acceptable solutions D1/AS1

## HBSQCP Handrail Bracket

- Fixing plate machined from 4mm thick stainless steel
- 4 countersunk holes for easy fixing to wall stud
- Square self fixing cover plate
- Recommended spacing maximum 1000mm

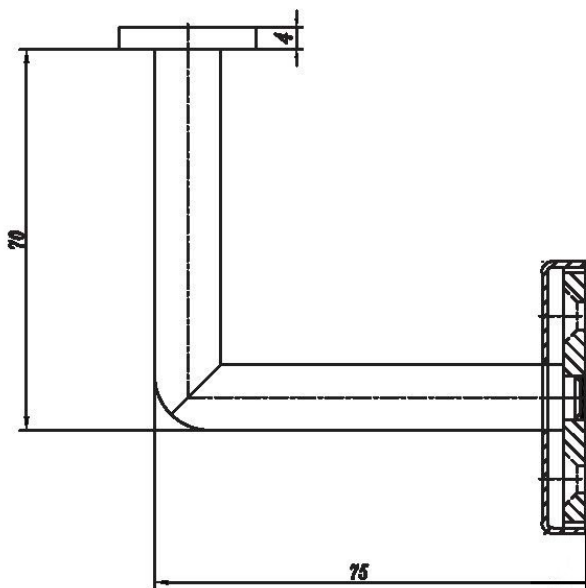

Also available without saddle  
Code HBSQCPnh





Handrail Fittings Ltd  
0800 HANDRAIL  
0800 426372

**HF** **HANDRAIL FITTINGS Ltd**  
Best Price - Best Quality - Best Service

Handrail Bracket - Modena Nil  
Product Code: HBR20S

HBR20S handrail bracket

Saddles to fit curved or flat tube

Also available as weld on HBR20nh

Manufactured from the highest  
quality AISI 304 & 316 stainless steel

Available in satin and mirror finish

This handrail bracket complies with BIA  
acceptable solutions D1/AS1



## HBR20 Handrail Bracket

- 20mm diameter solid rod
- concealed fixing into wall with a lag screw
- 12mm diameter rod upright
- Weld on or saddles available
- Recommended spacing maximum 800mm

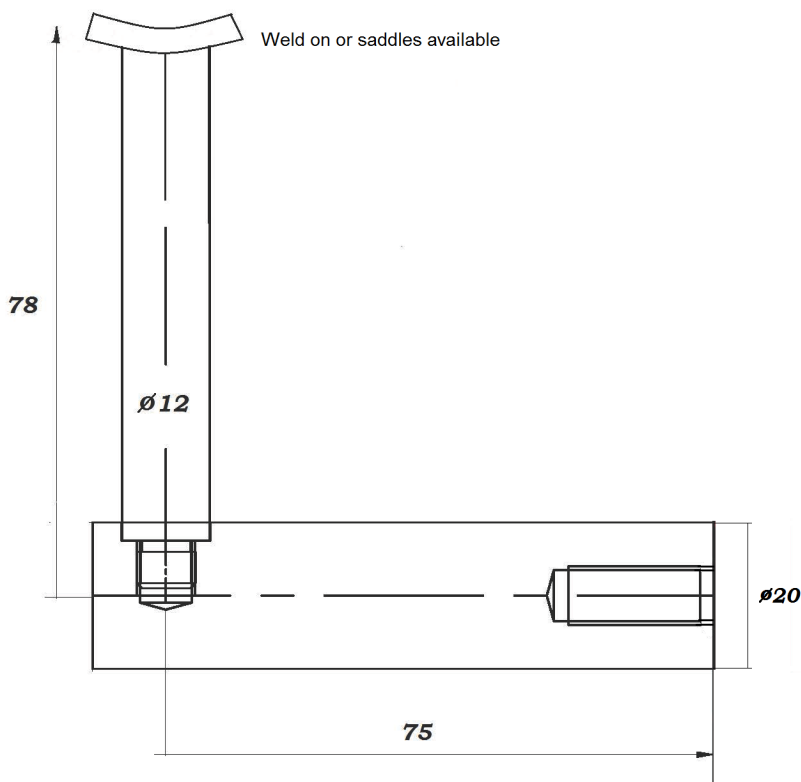

Also available without saddle  
Code HBR20nh







Handrail Bracket - Modena Pico  
Product Code: HBR20WS

HBR20WS handrail bracket

Weld on or saddles available

8mm lag screw supplied

AISI 304 & 316 stainless steel

Manufactured to the highest quality

Available in satin and mirror finish

This handrail bracket complies with BIA  
acceptable solutions D1/AS1

**HBR20W Handrail Bracket**

- 30mm diameter base flange
- 20mm diameter solid rod
- concealed fixing into wall with lag screw supplied
- 12mm diameter rod upright
- Weld on or saddles available
- Recommended maximum spacing 800mm

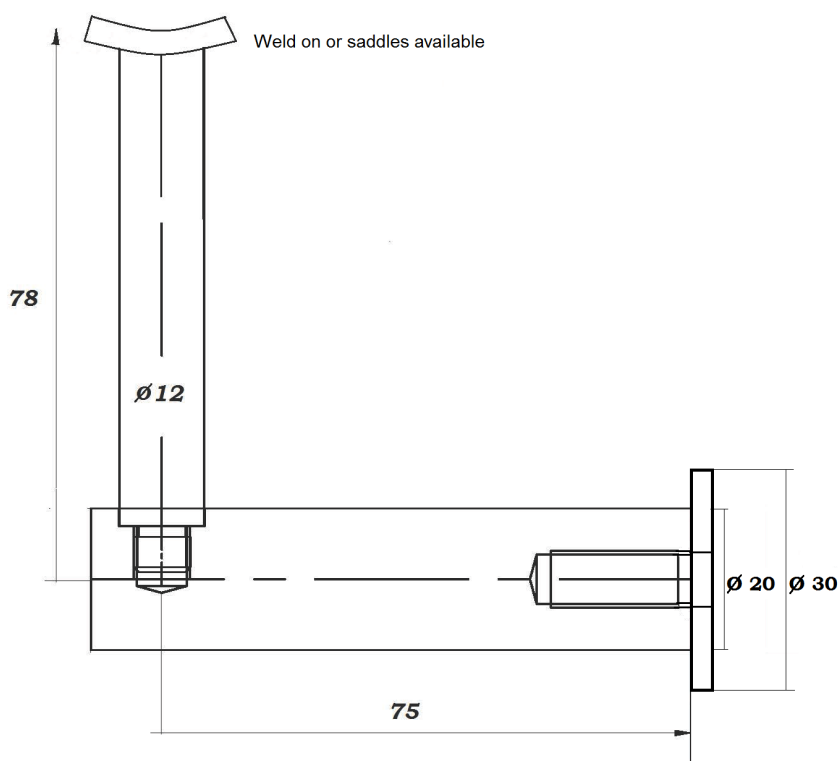

Also available without saddle  
Code HBR20Wnh





Handrail Bracket - Modena Grande  
Product Code: HBR20BS

HBR20BS handrail bracket

Weld on or saddles available

Manufactured from the highest  
quality AISI 304 & 316 stainless steel

Available in satin and mirror finish

This handrail bracket complies with BIA  
acceptable solutions D1/AS1

**HBR20 Handrail Bracket**

- 56mm diameter base flange
- 20mm diameter solid rod
- concealed fixing into wall with a lag screw
- 12mm diameter rod upright
- Weld on or saddles available
- Recommended spacing maximum 1000mm

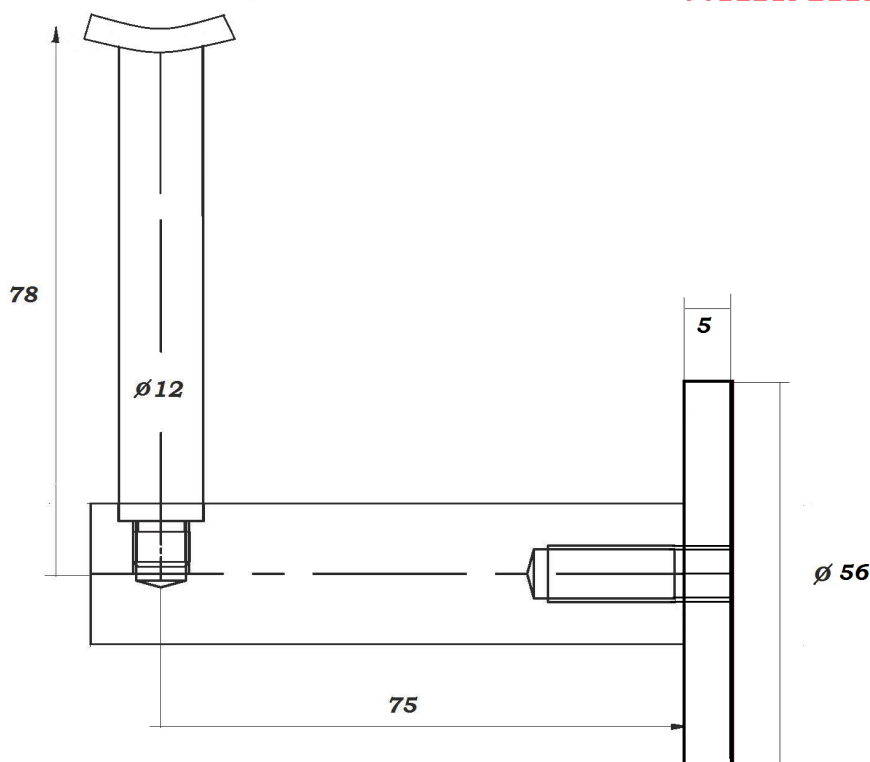

Also available without saddle  
Code HBR20Bnh





## Handrail Bracket - Basso Glaze Product Code: HBG40S

HBG40S handrail bracket for glass

Weld on or with saddles

AISI 316 grade stainless steel Manufactured  
to high quality specifications

Available in satin and mirror finish

This handrail bracket complies with BIA  
acceptable solutions D1/AS1

### HBG40S Handrail Bracket for glass

- 40mm diameter bases 10mm thick
- Solid construction
- Bushes and washers included
- 12mm diameter rod upright
- Weld on or saddles available
- Recommended spacing maximum 1000mm

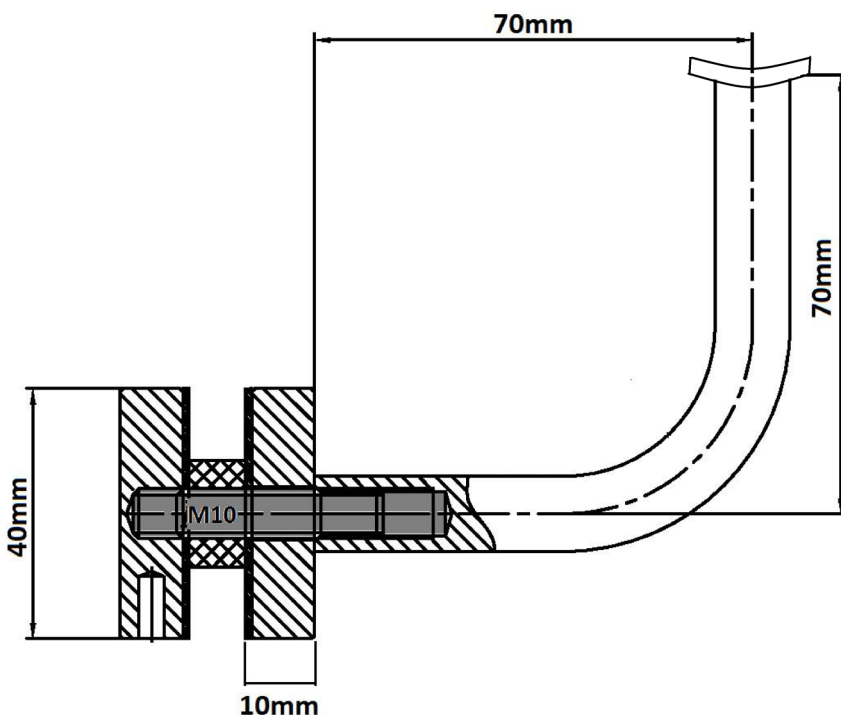

Also available in without saddle  
Code HBG40nh

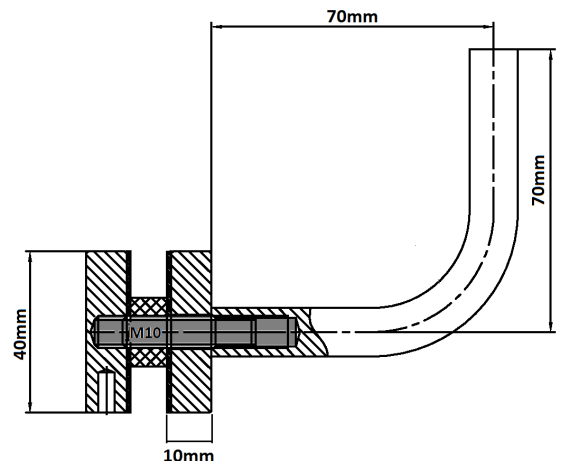
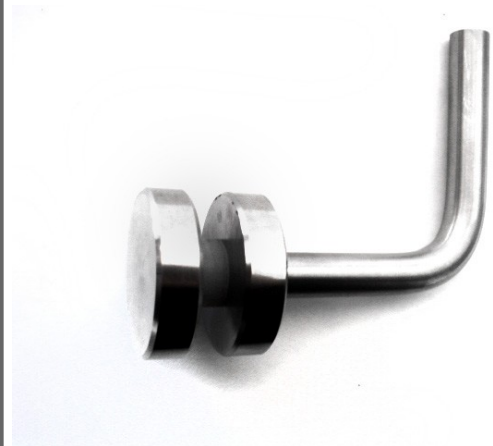



## Handrail Bracket - Trivoli Glaze Product Code: HBG50

HBG50 handrail bracket for glass

Weld on or with saddles

AISI 304 stainless steel

Manufactured to high quality specifications

Available in satin finish

This handrail bracket complies with BIA  
acceptable solutions D1/AS1

## HBG50 Handrail Bracket for glass

- 50mm diameter tapered buttons
- Solid construction
- Bushes and washers included
- 12mm diameter rod upright
- Weld on or saddles available
- Recommended spacing maximum 1000mm

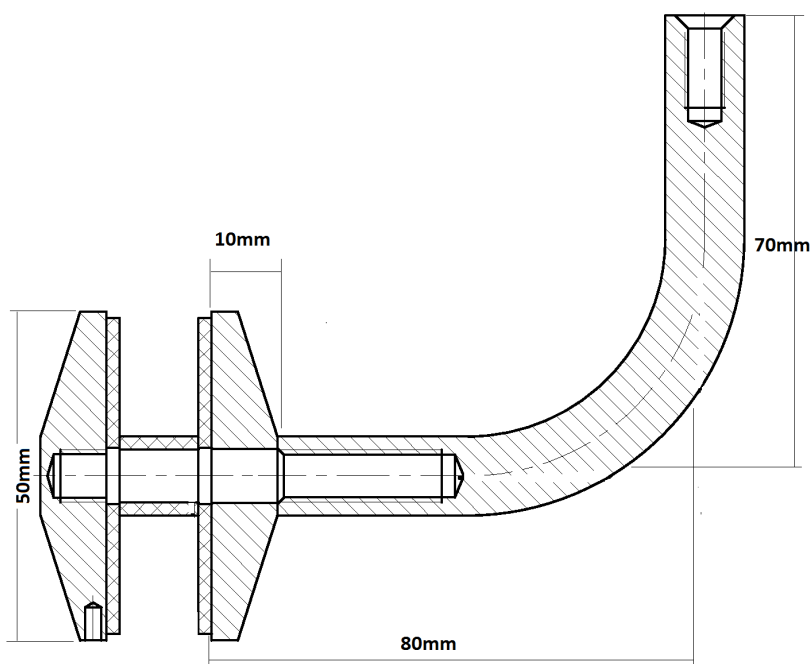

Also available with saddles  
Code HBG50S



Handrail Fittings Ltd  
0800 HANDRAIL  
0800 426372

**HF** **HANDRAIL FITTINGS Ltd**  
Best Price - Best Quality - Best Service



## Handrail Bracket - Milano Glaze Product Code: HBG56

HBG56 handrail bracket for glass

Available as weld on or with saddles

AISI 304 & 316 stainless steel

Manufactured to high quality specifications

Available in satin & mirror finishes

This handrail bracket complies with BIA  
acceptable solutions D1/AS1

### HBG56 Handrail Bracket for glass

- 56mm diameter bases to match Milano (HBFCP) wall bracket
- Solid construction
- Bushes and washers included
- 12mm diameter rod upright
- Weld on or saddles available
- Recommended spacing maximum 1000mm

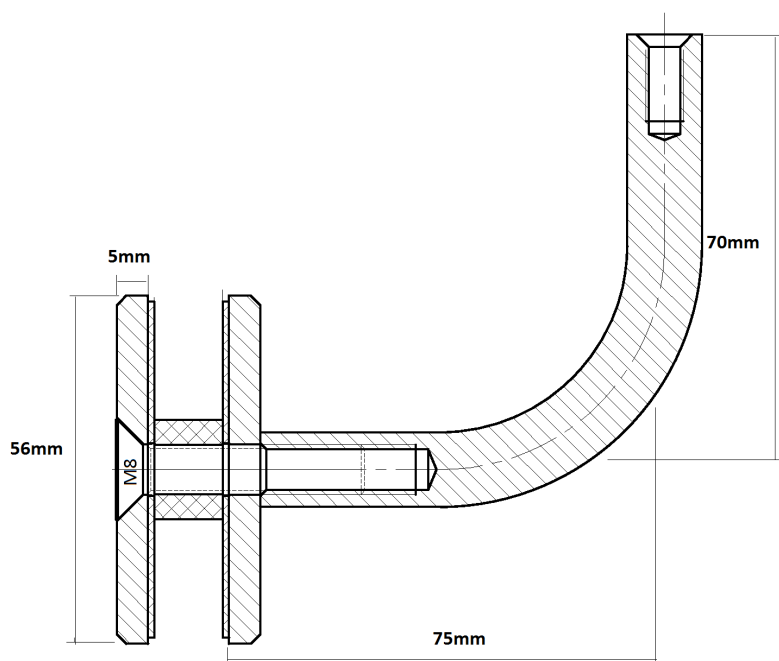

Visible 8mm countersunk  
screw fixing



Handrail Bracket - Modena Glaze  
Product Code: HBGR20

HBGR20 handrail bracket for glass

Weld on or with saddles

Manufactured from the highest  
quality AISI 316 grade stainless steel

Available in satin & mirror

This handrail bracket complies with BIA  
acceptable solutions D1/AS1



**HBGR20 Handrail Bracket for glass**

- 56mm diameter base and 20mm Rod to match Modena Grande HBR20B wall bracket
- Solid construction
- Bushes and washers included
- 12mm diameter rod upright
- Weld on or saddles available
- Recommended spacing maximum 1000mm

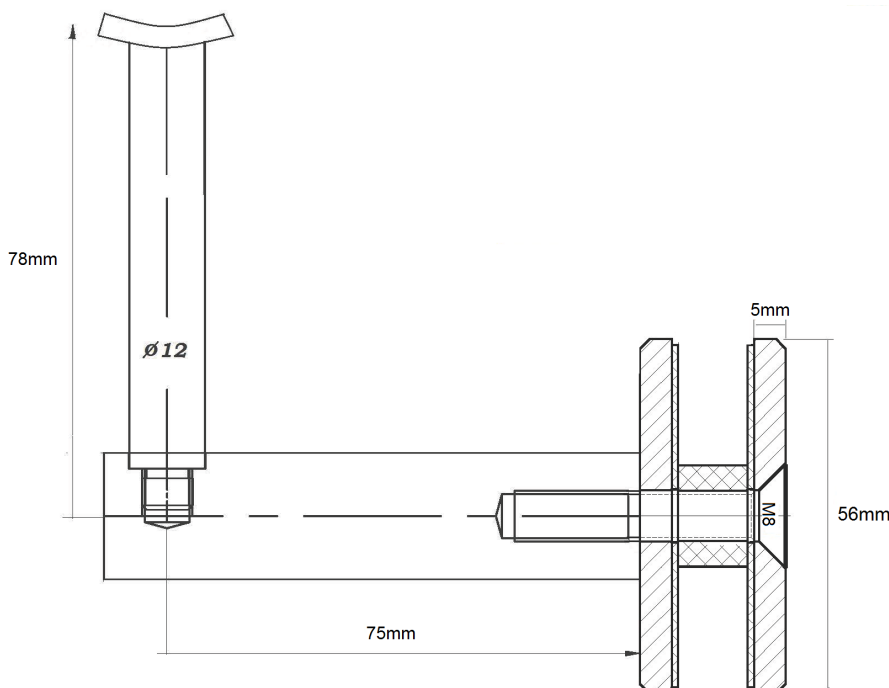

Visible 8mm countersunk  
screw fixing



**Handrail Fittings Ltd**  
**0800 HANDRAIL**  
**0800 426372**





## Handrail Bracket - Quadro Glaze Product Code: HBGSQS

HBGSQ square handrail bracket for glass

Weld on or with saddle AISI

316 satin stainless steel

All bushes and washers included

No visible fixings

Manufactured to high quality specifications

This handrail bracket complies with BIA  
acceptable solutions D1/AS1

## HBGSQ Handrail Bracket for glass

- 50mm x 50mm square bases
- Solid construction
- Bushes and washers included
- 12mm square rod upright
- Weld on or saddles available
- Recommended spacing maximum 1000mm

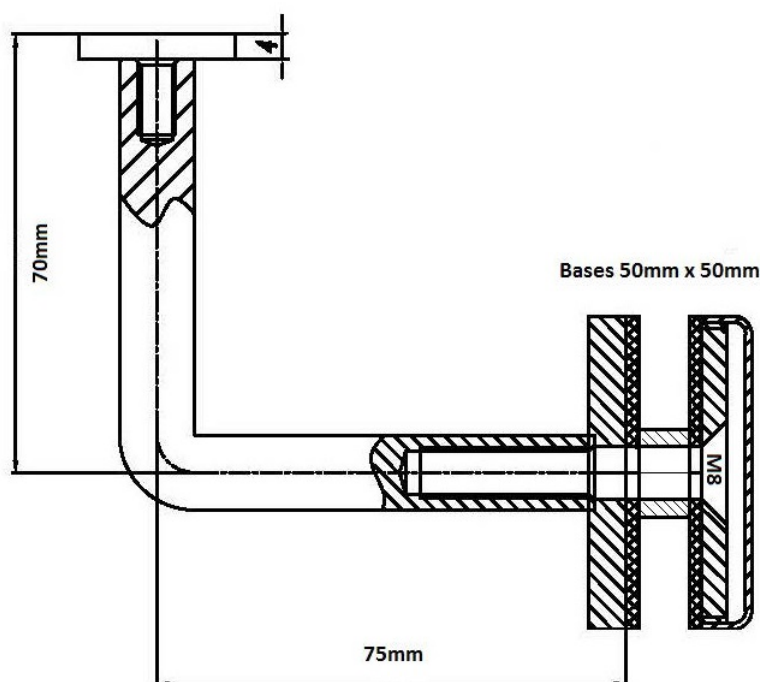

Available as weld on  
Code HBGSQnh



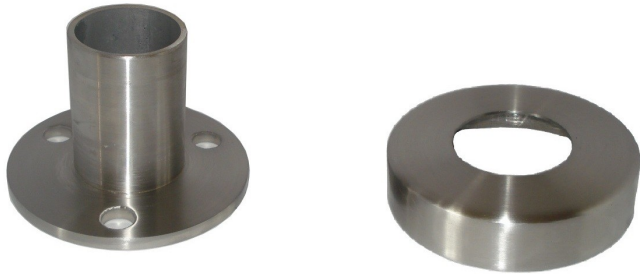

Base Plate with Cover (optional)  
Product Code: BP105 & CP110

Base plate for fixing post to floor

To fit 50.8mm tube 1.5mm wall

Also available to fit 38.1mm tube

3 fixing holes

AISI 304 and 316 stainless steel options

Available in satin & mirror finish

Manufactured to high quality specifications

## Base Plate BP105 AISI 304

Base Plate with post  
105mm diameter  
Fits 50.8mm tube  
3 fixing holes

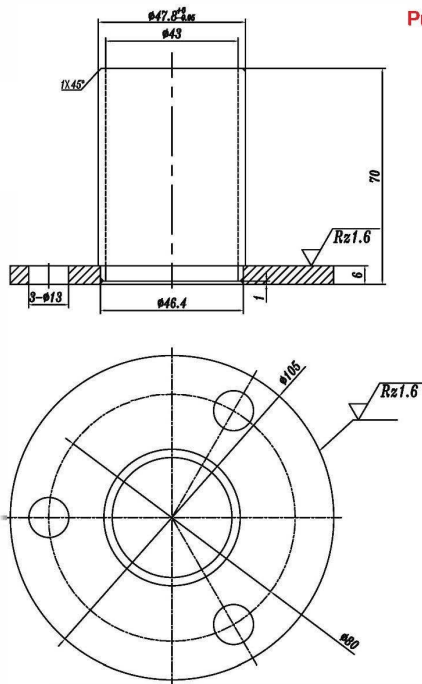

Product Code: BP105

## Optional Cover Plate CP110 AISI 316

Product Code: CP110

To Fit Base Plate BP105  
AISI316 Satin

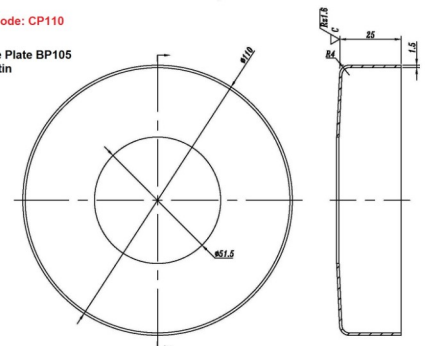



Tactile Handrail Indicator  
Product Code: TB12

Tactile Handrail Indicator

Tap In interference fit

AISI 316 stainless steel

Manufactured to high quality specifications

Available in satin and mirror finish

## Tactile Handrail Indicators

- For use on handrails as an indicator for the sight impaired that gives warning of the beginning and end of a handrail
- Also used along the top of a handrail as a skateboard deterrent
- 
- To install, drill a 6mm hole in the desired position on top of the rail and tap the button in with a soft faced hammer
- 
- The interference fit ensures a permanent fix
- 
- Available in 316 satin and polished finish

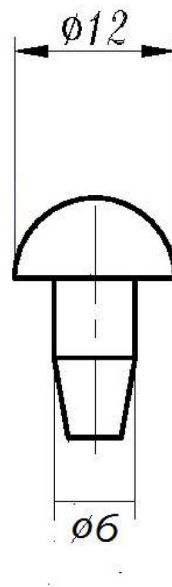

Handrail Fittings Ltd  
0800 HANDRAIL  
0800 426372

## End Caps for tube finishing

Interference fit - no welding required

To fit 1.5mm wall thickness

Sizes: 50.8, 44.45, 38.1, 31.8, 25.4

AISI 304 and 316 options

Available in satin or mirror finish

Manufactured to high quality specifications



### Codes & material:

50.8mm	EC50 304 & 316 satin & mirror
45.45mm	EC45 304 & 316 satin & mirror
38.1mm	EC38 304 & 316 satin & mirror
32.1mm	EC32 304 satin only
25.4mm	EC25 304 satin only



## End caps for 50x25 square section 316 satin finish Code ECSQ50

